

PALCO™

FASTFIT



Uniclass L412:L387: P41:N3243	EPIC D122:C471: X412:Y423
CI/SfB	(35.3) Xh2 (K2)

Ceiling Access Panels

Designed for plaster finished ceilings.

Available fire rated.

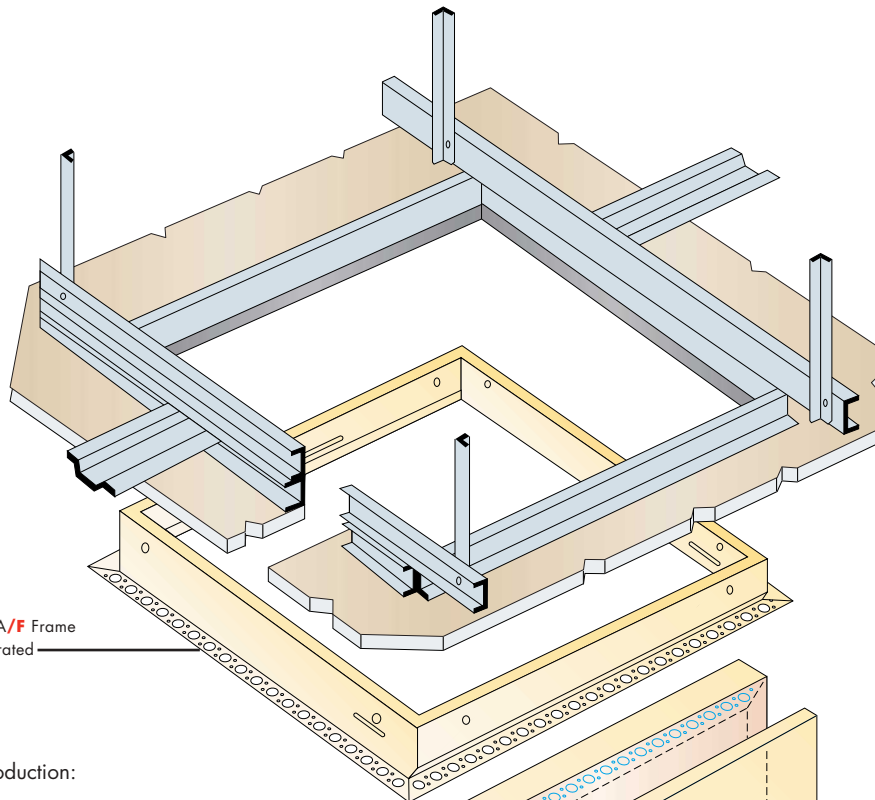

CP1A/F Frame
Illustrated

Introduction:

FastFit Range 1 steel panels provide protected openings in jointless suspended ceilings for access to building engineering services. Panel selected is made from combinations of two frame and three door types. Fire rated versions of CP1A, CP1B and CP1C are available as CP1A/F, CP1B/F and CP1C/F.

CP1A

Combines a plasterboard clad door with a simulated edge bead and a simulated beaded frame, to give a flush finish when "taped and jointed". For use in ceilings constructed of plasterboard screw fixed to a metal suspension system or plasterboard to timber joists.

A picture frame version is available on request.

CP1B

Combines a flush metal door with a simulated beaded frame for use as above.

CP1C

Combines a flush metal door with a 25mm wide picture frame and used as above or in plastered ceilings with metal or lathe backgrounds.

CP1D

Combines the same characteristics as our CP1A however includes a fixed hinge, which is recommended when your required size exceeds 600 x 600mm

All doors in the range have concealed hinges or pivots with key operated locks for downwards opening. They are removable for repair purposes or to assist installation. The metal faced doors are either polyester powder coated RAL 9010 or dust primed only for on site decoration. The plasterboard faced doors are factory clad for joint filling on site.

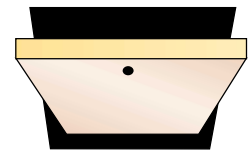

Fig. 2 Panel Ref. CP1A/F

Plasterboard clad door with simulated edge bead and simulated edge bead frame for joint fill on site. Snap in plastic plug and collar in keyhole (non fire rated) and steel plug screwed into keyhole (fire rated).

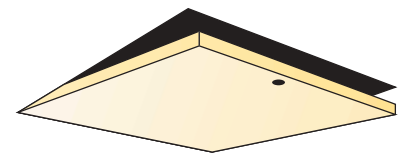

Fig. 3 Panel Ref. CP1B/F

Flush metal door with simulated edge bead. Snap in plastic plug and collar to keyhole.

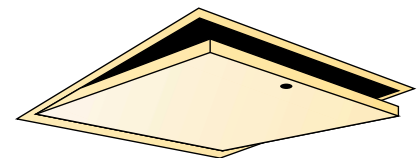

Fig. 4 Panel Ref. CP1C/F

Metal door with picture frame. Snap in plastic plug and collar to keyhole.

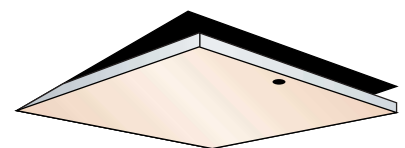

Fig. 5 Panel Ref. CP1D

Plasterboard clad door with fixed hinge and simulated edge bead frame for joint fill on site. Snap in plastic plug and collar in keyhole.

Safety recommendation:

CP1A and CP1A/F can have CAD (Controlled Action Device) fitted on panels larger than 600 x 600mm. CP1B/F and CP1C/F to have either dampers or safety chains fitted on panels larger than 900 x 900. These are available on request.

Manufacture:

Panel CP1A & CP1D Door leaf 0.9mm thick electro-galvanised mild steel tray 25mm deep with simulated edge bead formation incorporating 12.5 thick plasterboard. CP1B and CP1C: Door leaf 0.9mm thick electro-galvanised mild steel flush faced tray 23mm deep.

Panels CP1A , CP1B & CP1D Frame : 1.2mm thick electro-galvanised mild steel with simulated edge bead formation.
 Panel CP1C: Frame: 1.2mm thick electro-galvanised mild steel

Finish: Polyester powder coated RAL 9010 or dust primed for on site decoration.

CP1A: Concealed pivot
 CP1B and CP1C: Continuous steel hinge bolted to frame. Budget locks fitted as standard on all models.
 CP1D: Fixed hinge
 CP1A – Plastic plug and collar – CP1A/F – steel screw in keyhole.
 CP1B, CP1C and CP1D plastic plug and collar in keyhole.

CP1B/F and CP1C/F as as CP1B and CP1C but incorporating sealing plates to all sides of frame plus 10mm Megadeco board backing to door trays.

Options:

Infilled insulation, double doors, dampered action doors, fully perforated doors, grilles and downlighter apertures. Special requirements such as stainless steel, special colours or paint finish, lift out or inward opening available on request. For alternative locks see the Lock Section.

Stock sizes available

- Single door leaf
- 300 x 300
- 450 x 450
- 600 x 600
- All other sizes are available on request.

Design Consideration:

Apertures formed in ceilings to accept access panels should be constructed to resist forces occasioned by operating panels. Structural aperture sizes for panels required:
 All CP1 panels: $W+5 \times L+5$

Operation:

All standard FastFit Range 1 panels incorporate budget locks operated by keys (supplied by PALCO) after removing plugs from keyholes.

Ordering:

Use product code (ie. CP1A), quote dimensions, finish, hinge side and any special requirement.

Refer to PALCO

Technical Services:

We are pleased to advise on the use of our standard products at any stage of a building contract and to provide designs for special applications.

Reference:

We reserve the right to modify the products and specifications in keeping with a policy of continuous improvement and development.

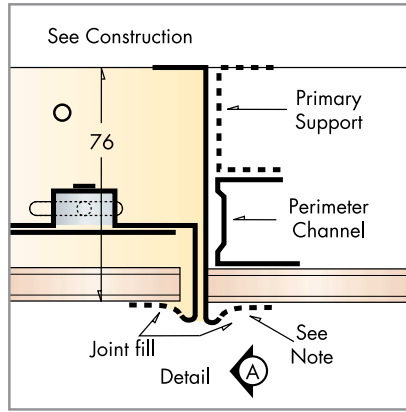

Fig. 6 Note: Special edge formation as shown in Fig. 9

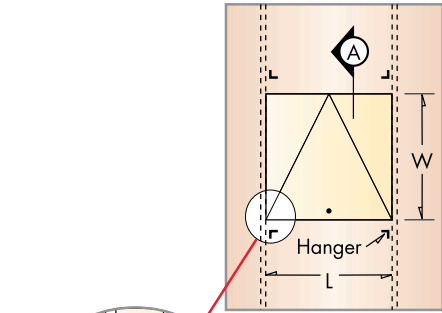

Fig. 8
 Panel Ref.
 CP1A & CP1A/F

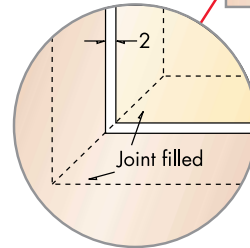

Fig. 7

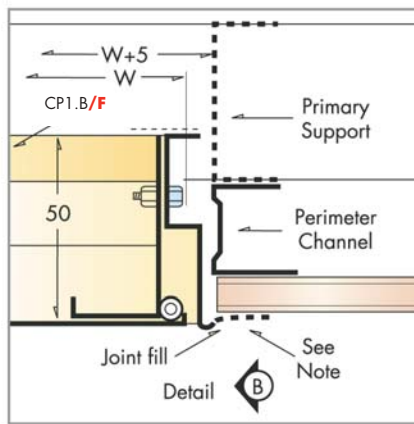

Fig. 10 Note: Special edge formation as shown in Fig. 9

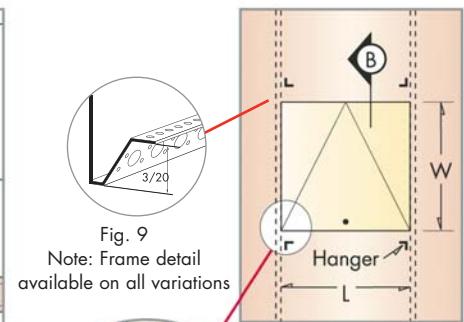

Fig. 12
 Panel Ref.
 CP1B & CP1B/F

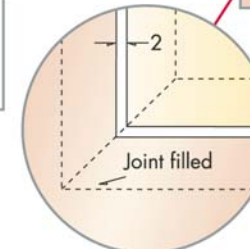

Fig. 11

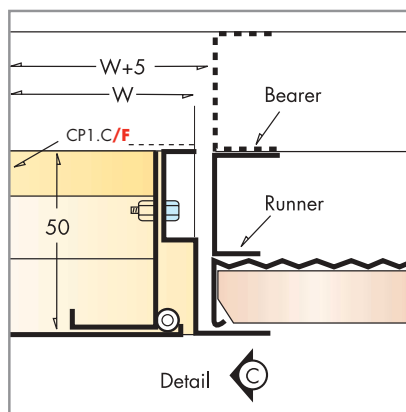

Fig. 13

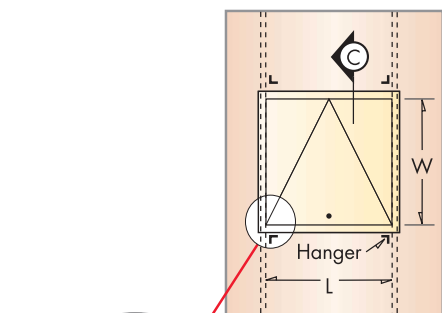

Fig. 15
 Panel Ref.
 CP1C & CP1C/F

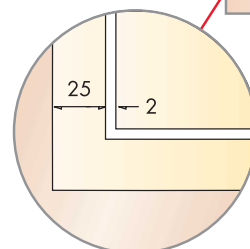

Fig. 14

